

## Master Flash® Standard



Select an appropriate Master Flash® Standard with a pipe range that goes below and beyond fitting. If necessary, use the lines clearly shown on the flashing to trim an opening 20 - 30% smaller than pipe diameter. For the steep roof slopes or higher corrugation of the profile, bigger size of Master Flash® should be chosen.



Slide the Master Flash® down the pipe, using a non-petroleum-based lubricant to ease installation.



Press Master Flash® down, bending it to conform to roof profile or irregularities. A blunt tool will help to form flashing to tight roof angles.



Apply sealant between the base of the flashing and the roof.

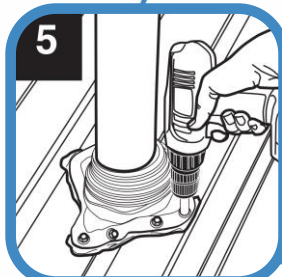

Fix the flashing to the surface using self-drilling screws assembled with washers. The spacing between the screws should not exceed 38 mm (1,5 inch.).